

# 335 HTS

## A TRUE COMPETITOR

The sporty disposition of the 335 is immediately apparent, especially in a two-way color way, and matches the handling characteristic of this model. This cruiser checks all the boxes and is sure to please all performance fanatics regardless of weather conditions.

The dynamic outline is complimented by large glass areas occupying most of the main deck, with bow skylights and hull windows making sure the interior is nice and bright. The helm area is protected by a retractable sunroof, which can be quickly moved back for better ventilation.

Come on board and be immediately amazed by the vast cockpit area, the highlight of the 335. With three separate leisure areas everyone will find their spot. The aft facing sun pad can be extended by a removable mattress while the elevated seat next to the helm is great for keeping the driver company. The main leisure area faces a wet bar complete with a fridge and can comfortably seat six.

When stationary, the bow sundeck is a great place to catch some sun and relaxation, especially with the back rests propped up for comfort. Don't forget about the large bath platform, which comes standard and will make all water-based activities even more fun.

Down below, all guests can take full advantage of the well-equipped galley with plenty of storage and a bathroom with separate cabin for head and shower - a great solution for keeping the towels and toiletries dry. Both double cabins offer privacy thanks to full sized doors and provide enough headroom in all the crucial places. The fit and finish is up to Galeon standards with a variety of interior designs to choose from and a wide array of optional equipment.

The 335 HTS is a complete sport cruiser with enough performance and livable space for any day excursion with an overnight stay.

SPORT  
CRUISER LINE



The 335 is a stunning sport cruiser with design and performance to stand out in any marina. Based on one of Galeon's all-time best sellers, its mature construction offers plenty of clever features and great, all around handling.









# 335 HTS

The sport cruiser line is highlighted by excellent handling capabilities



Striking design and smooth cruising of the 335 HTS



Notice the large bath platform for water based activities





## WALNUT

Below deck find the saloon with a galley area and a sizable dinette

335 HTS





The dining and rest area down below



A well equipped galley area



The forward cabin will sleep two with extra space for storage



The second cabin with a double bed offers plenty of space





## OAK

The saloon down below is bright and spacious for a yacht in this segment

335 HTS





The galley area will hold plenty of supplies —



The forward cabin sleeps two —



The guest cabin has a large double bed and holds extra storage —



A closed-off shower will help to keep the bathroom dry and tidy —





— Precise handling and great visibility from the helm



— Social leisure area next to the helm



— Plenty of space for fun and relaxation on board of the 335 HTS



— Use the extra mattress to create a large sundeck facing the aft

# 335 HTS

# A TRUE COMPETITOR

## Layouts

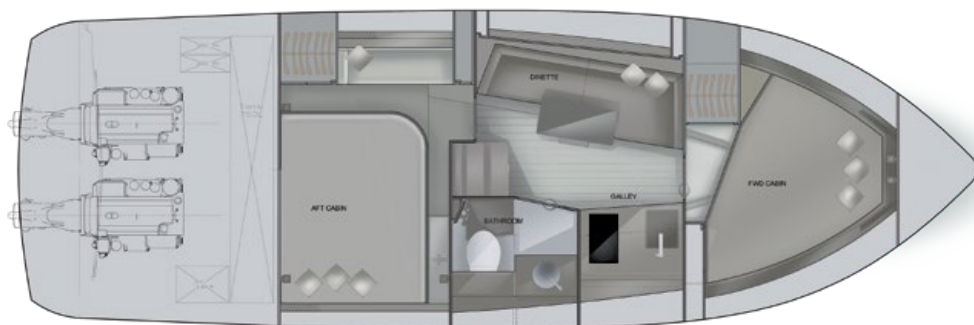

## Technical Specification

Length of the hull	[m]	9.98
Length overall	[m]	10,20 / 10,90*
Beam of the hull	[m]	3.30
Beam overall	[m]	3.35
Draft max <sub>1</sub>	[m]	0.86
Bridge clearance <sub>2</sub>	[m]	3.40
Height to transport	[m]	3.62
Fuel tank capacity	[dm <sup>3</sup> ]	630 or 750**
Water tank capacity	[dm <sup>3</sup> ]	215
Grey water tank	[dm <sup>3</sup> ]	75 (or 0)
Black water tank	[dm <sup>3</sup> ]	60 (or 140)
Mass of Light Craft Condition <sub>3</sub>	[kg]	5892
Maximum Load	[kg]	1800
Min. engine (-s) power	[kW/hp]	2 x 169 / 230
Max. engine (-s) power	[kW/hp]	2 x 261 / 350
Crew limit		8
Category		B

<sub>1</sub> - without propellers    <sub>2</sub> - Max. height from water line at draft min.    <sub>3</sub> - minimum mass with base engines

\* - with extended stern platform    \*\* - with extended tank

TEAM FOR DESIGN  
ENRICO GOBBI

**VOLVO  
PENTA**

**MERCURY**

